

# Python Short Link Chain G80

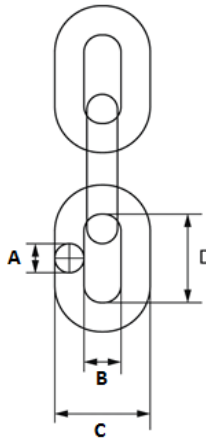

A (mm)	W.L.L tonnes	B (mm)	C (mm)	D (mm)	Weight kgs
7	1.5	9.1	25.9	21	0.34
8	2	10.4	29.6	24	0.54
10	3.15	13	37	30	0.82
13	5.3	16.9	48.1	39	1.5
16	8	20.8	59.2	48	2.3
20	11.2	26	74	60	3

- **Ultimate load is 4 times the Working Load Limit**
- **High Tensile Heat Treated Alloy Steel**
- **Black Painted Finish**
- **Conforms to BS EN 818-2**
- **Working temperature range -40 °C to +400 °C (reductions in W.L.L)**
- **Proof Tested at 2.5 times the Working Load Limit**